

BMW Parts and Accessories Installation Instructions



Alarm Kit Installation Instructions

BMW Z4 (E85) Vehicle Production 10/2003 - ON

Retrofit Kit - P/N: 65 73 0 309 944

SUGGESTED INSTALLATION TIME; 1.5 HOURS*

* Includes vehicle-coding procedures.

These instructions were developed especially for BMW vehicles and are not to be compared to any existing instructions for vehicles other than BMW. No methods other than those specified in this document are to be used to install this alarm retrofit kit in Z4 vehicles.

PARTS INFORMATION

Contents of Kit – P/N 65 73 0 309 944

Description	Qty	BMW Part Number
Hood switch	1	61 31 8 374 745
Bracket (for switch)	1	61 31 6 915 326
M6 hex nut w/captive flat washer	3	11 61 1 708 413
Siren (US) w/built in tilt sensor	1	65 75 6 940 677 or 65 75 6 942 431
Bracket (for siren)	1	65 75 6 937 448
ST 4.8-2 cage clip	1	07 12 9 904 323
ST 4.8 x 16 hex head screw	1	07 11 9 901 299
MDD interior protection module	1	65 75 6 937 080 or 65 75 6 944 875
Bracket (for MDD module)	1	65 75 6 908 839
M5 x 10 Torx 25® head screw	2	54 31 8 234 675

REQUIRED ADDITIONAL PARTS*

* Only for vehicles without BMW Assist option

Description	Qty	BMW Part Number
Oddments tray (shielded) black	1	51 46 7 073 533
Oddments tray (shielded) gray	1	51 46 7 073 534

DO IT RIGHT THE FIRST TIME, ON TIME, EVERY TIME

Contents

Section	Page
1. Alarm Hood Switch Installation	4
2. Alarm Interior Protection Module Installation	6
3. Alarm Siren/Tilt Sensor Installation	9
4. VEHICLE CODING	11

1. Alarm Hood Switch Installation

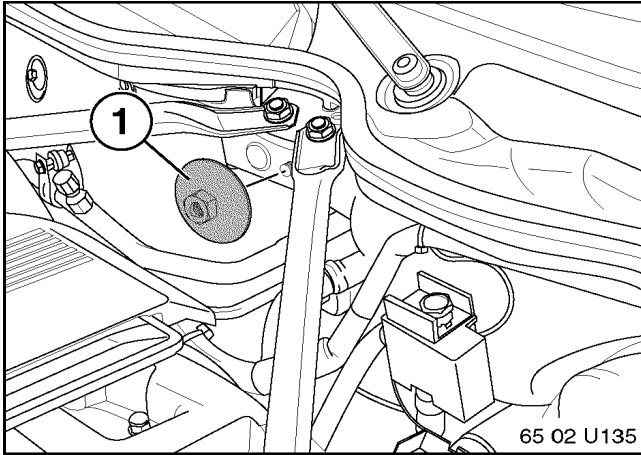

1.1

Disconnect battery negative terminal.

1.2

Locate and remove plastic fastener (1) in engine compartment near center firewall.

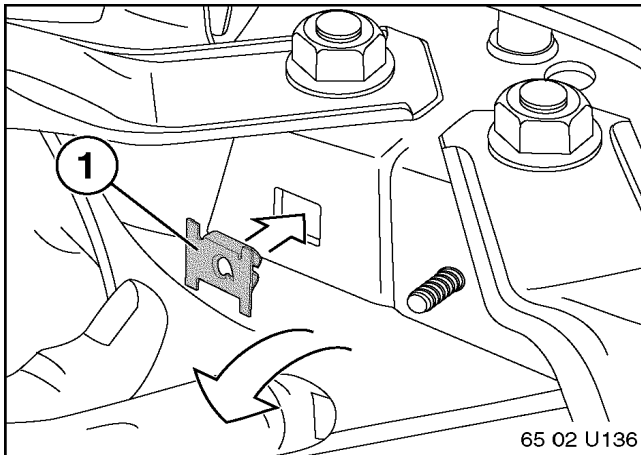

1.3

Pull down cover to reveal rectangular shaped opening. Install cage clip by pushing clip into opening until clip seats into position.

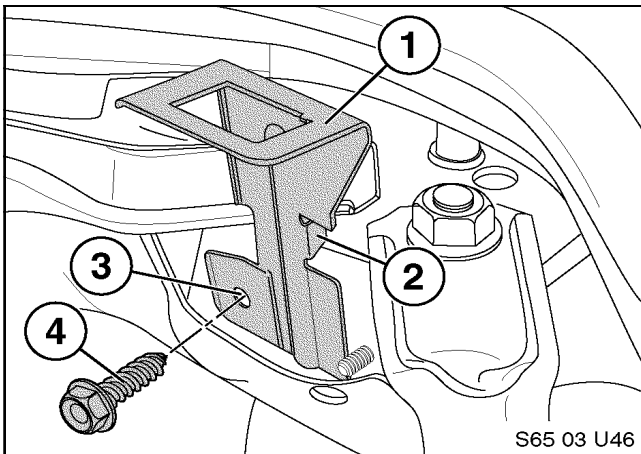

1.4

Position hood switch bracket (1) so that right angle tab (2) makes contact with horizontal surface while round hole (3) is aligned with center opening of cage clip. Secure bracket (1) in place with self-tapping 4.8 x 16 hex head screw (4) as shown.

1. Alarm Hood Switch Installation

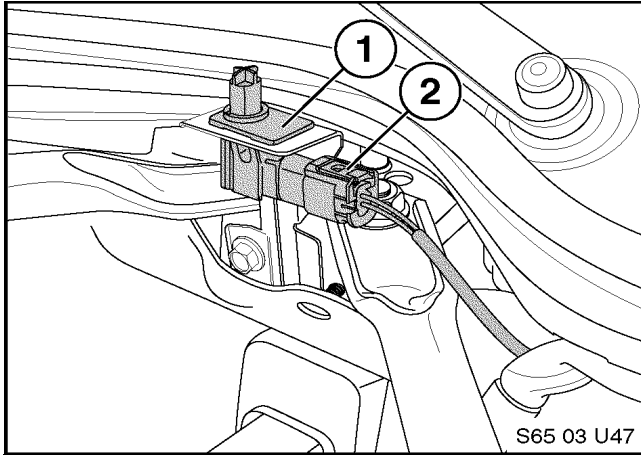

1.5
Install hood switch (1) into bracket.

1.6
Locate 3-position hood switch connector found behind brake master cylinder booster. Remove securing tape and neatly direct hood switch connector and harness to bracket area.

1.7
Remove protective cover and install connector (1) to hood switch (2).

1.8
Reposition cover over assembly and secure in place with plastic fastener previously removed in step 2.

2. Alarm Interior Protection Module Installation

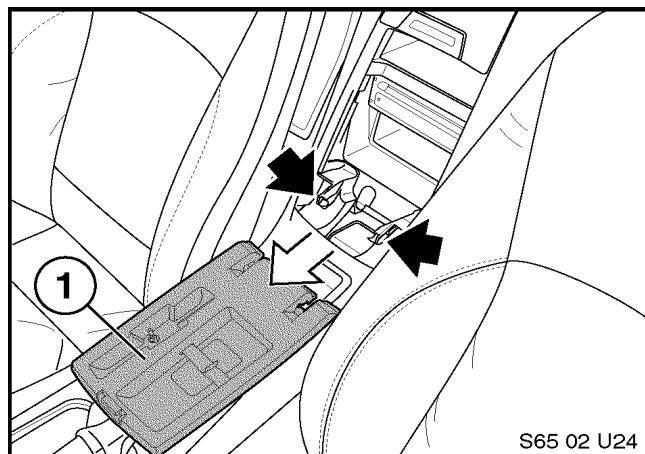

Note: Before proceeding, make sure hands are clean to prevent soiling of interior trim and parts.

2.1
Lower convertible top.

2.2
Remove pair of Phillips® head screws from mounting clips (black arrows). Firmly grasp oddments box cover (1) and pull forward to remove from mounting points as shown.

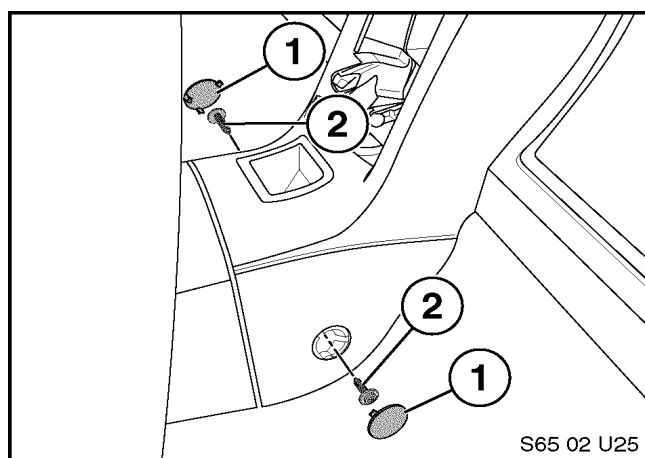

2.3
Move seats forward. Remove RH and LH covers (1) and mounting screws (2) as shown.

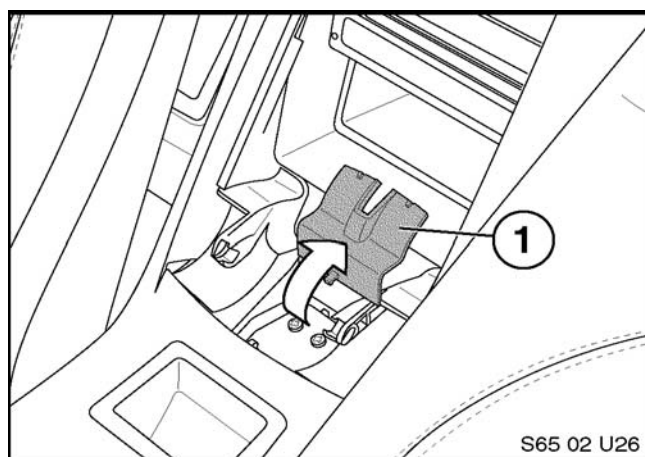

2.4
Pry out switch panel cover (1) exposing mounting screws as shown.

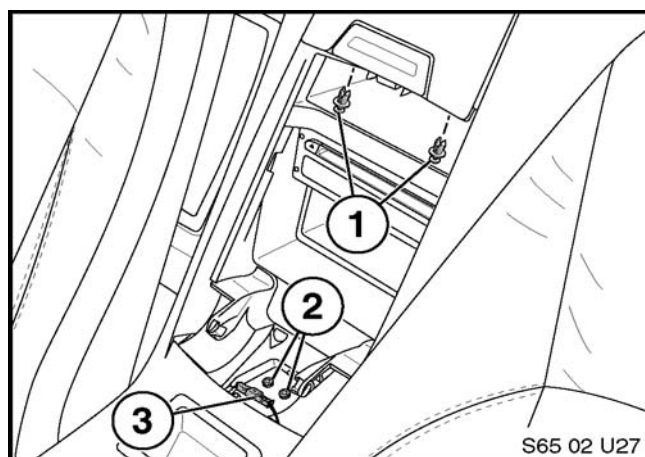

2.5
Remove pair of Phillips® head plastic rivets (1).

2.6
Remove pair of T20 Torx® head screws (2).

2.7
Disconnect connector attached to micro switch (3).

2. Alarm Interior Protection Module Installation

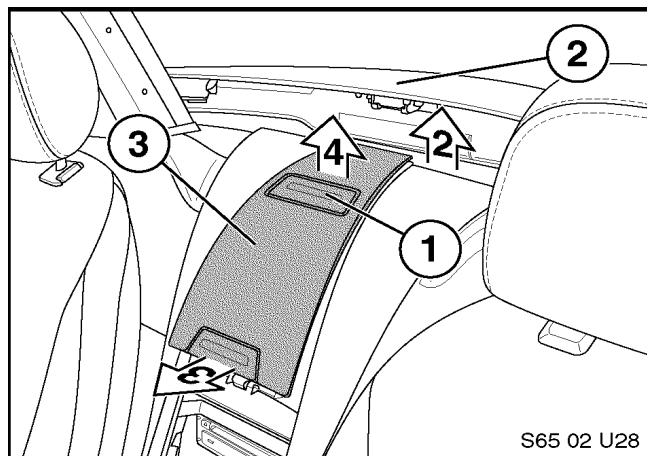

Note: Before proceeding further, the convertible top (2) must be positioned upward 2.0 inches (53 mm) from its locked position to allow disassembly of oddments upper cover.

2.8

Press roof lock release control (1).

2.9

Carefully pull up slightly on upper edge of oddments cover (arrow 2) while simultaneously pulling outward on lower edge of oddments cover (arrow 3) to allow oddments cover (3) to be removed upward (arrow 4).

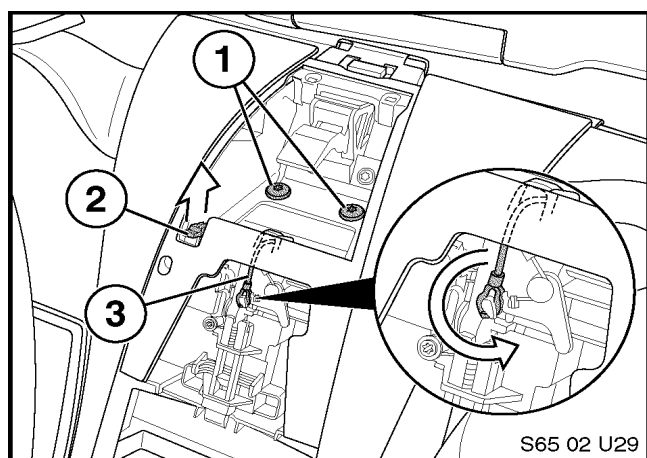

2.10

Remove pair of T30 Torx® head bolts (1).

2.11

Disconnect connectors (2) as shown.

2.12

Remove oddments box lock emergency release cord end "loop" (3) from cam. Route cord away from oddments box frame.

2.13

On BMW Assist option vehicle disconnect "SOS"/Roadside Assistance switch.

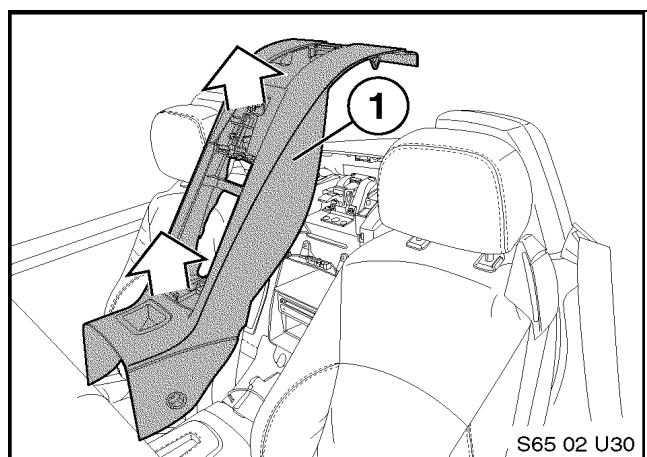

2.14

Remove oddments box (1) as shown.

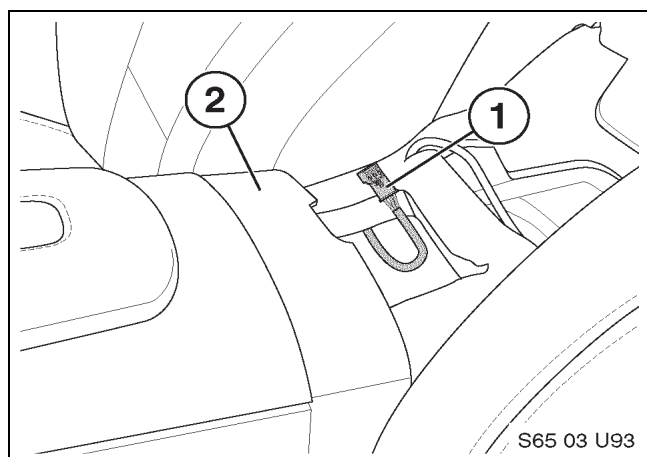

2.15

Locate alarm interior module 4-position black connector (1) frond under center console (2).

2. Alarm Interior Protection Module Installation

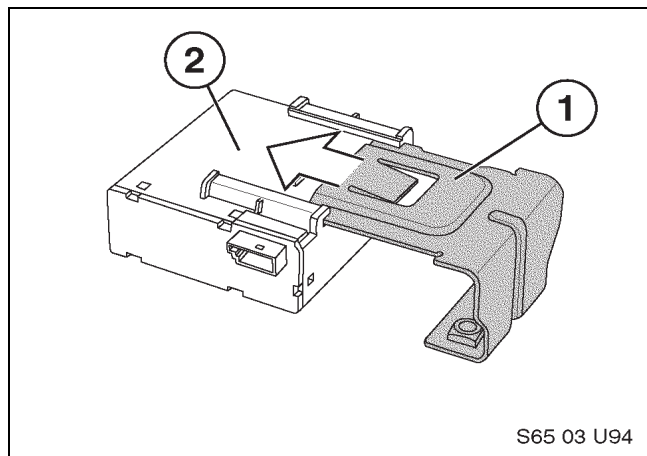

2.16

Slide mounting bracket (1) into mounting rails of alarm interior protection module (2) **specifically as shown** until bracket locks into place.

Note: It is possible to mount bracket from opposite end. Doing so will orient connector in undesirable position when mounting module/bracket assembly into position.

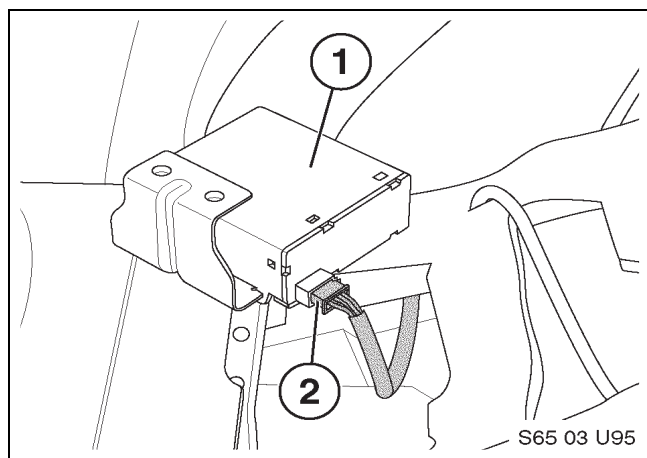

2.17

Connect alarm interior module connector (2) to module (1) as shown.

Note: connector must face RH (passenger's) side.

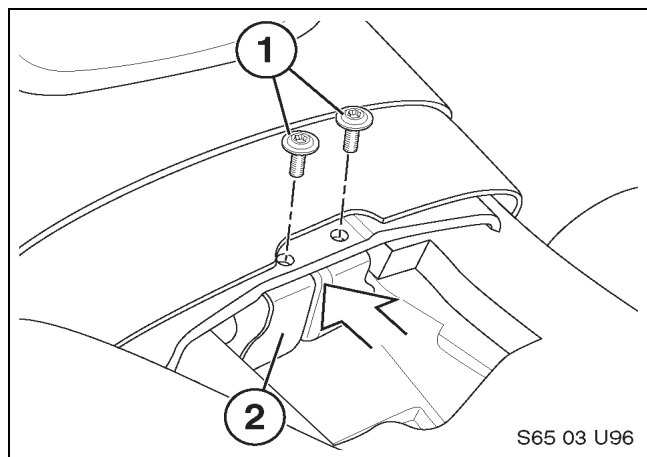

2.18

Position alarm interior module/bracket assembly (2) into center console so that pair of mounting holes on center console align with bracket holes. Secure in place with pair of T25 Torx® head screws.

2.19

On non BMW Assist option vehicle, replace oddments tray with shielded oddments tray. See page 1 for order information.

2.20

Reassemble all previously displaced or removed items.

3. Alarm Siren/Tilt Sensor Installation

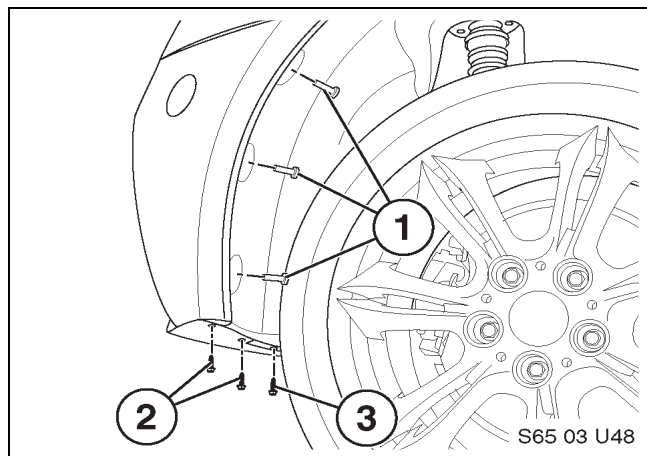

3.1

Remove the three plastic rivets (1) from RH rear wheel well as shown.

3.2

Remove the two hex head self tapping screws (2) and the one M5 x 12 hex head screw (3) from RH lower corner area of rear bumper as shown.

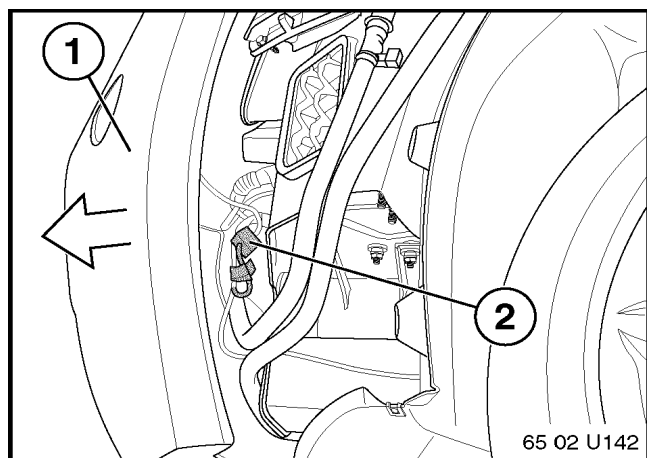

3.3

Slightly displace RH corner area of rear bumper (1) from RH wheel well area by about 10 inches (25.5 mm) to allow access to charcoal canister vent lines area as shown.

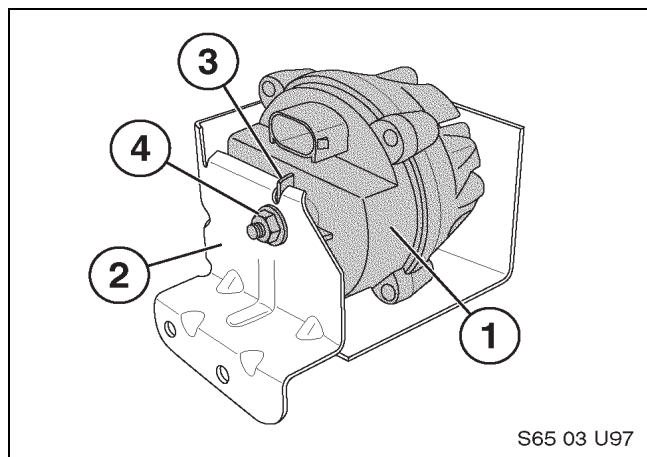

3.4

Position alarm siren (1) to mounting bracket (2) as shown.

Note: Make sure ridge directly below connector on siren (3) aligns with notch on bracket.

3.5

Secure siren (1) to bracket (2) using M6 nut with captive flat washer (4).

3. Alarm Siren/Tilt Sensor Installation

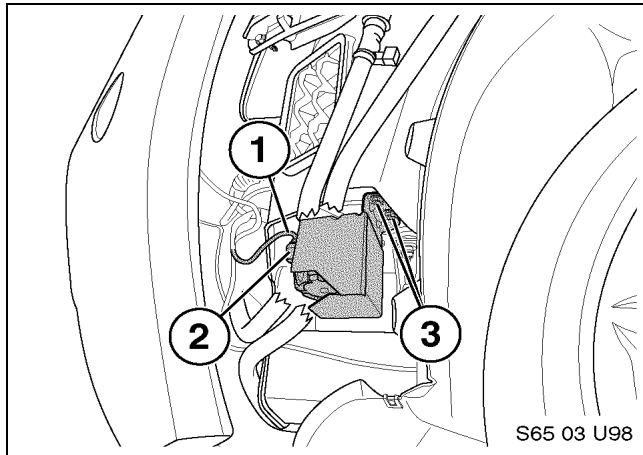

3.6

Locate 6-position black alarm siren connector (will require unwrapping securing tape and removing protective cover) found near the carbon canister vent lines.

3.7

Connect siren harness connector (1) to siren (2). Position alarm siren/bracket assembly so that pair of threaded studs (3) protrude through the pair of holes on bracket as shown. Secure alarm siren/bracket assembly in place with pair of M6 hex nuts with captive flat washers.

3.8

Re-assemble all previously displaced or removed items.

3.9

Re-connect battery negative terminal.

Installation is complete.

Continue with Vehicle Coding procedure.

4. VEHICLE CODING

After completion of above installation, the retrofit anti-theft alarm system (DWA) must be coded to the vehicle using DISPlus or GT1 as follows:

Note: Use coding software version CIP 10.1 or later versions.

Coding/Program Menu (CIP 11 is referenced for this procedure)

- Select 8 CIP
- Select Z
- Select E85
- Select "Load SW"
- "Have control modules been replaced on this car?"
- Select "No"
- "Control Module Selection" Menu
- Select Retrofits
- „Retrofitting Selection“ Menu
- Select Retrofits
- "Retrofits were added"
- Select DWA
- Select "Added"
- "Retrofitting anti-theft alarm system selected"
- Select "Continue"
- "Implement Measures Plan" Menu
- Select "Start"

At final report

- Select "Finish"

Customization of anti-theft alarm system features is possible by activating/deactivating-coded features found in Car and Key Memory as follows:

CKM Setting (Car Key Memory)

"Function Groups" Menu

Select "Anti-theft System" to set "Acknowledgement"

Options and select "Central Locking" to set locking options.

When selections are completed, select "Encode Car".

Upon completion of anti-theft alarm system coding, conduct alarm system test to verify functionality of selected Car Key Memory settings.